

**SCTK673 series** retro-fit (split-core) current transformer has been specially designed to facilitate their installation in new or already existing net works. They may be installed without opening any cable or bus-bar circuit. An internal precision resistor across the secondary winding of the CT provides a low safe voltage output. It can save time and the installation costs.

### ◆ Features

- Epoxy Potting, Double-screw fastening, safe, easy to install, portable
- Wide inner window, allowing clamping of big cables or bus-bars
- Wide range of sizes to accommodate all the existing installations

### ◆ Applications

- Current measurement, monitoring and protection for electrical wiring and equipment.
- Current and power measurement for electric motors, lighting, air compressor, heating and ventilation system, air-condition equipment and automation – control system.
- Current, power and energy monitoring device.
- Relay protection device.

### ◆ Circuit connection diagram

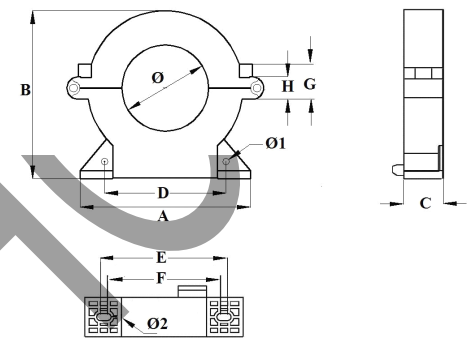
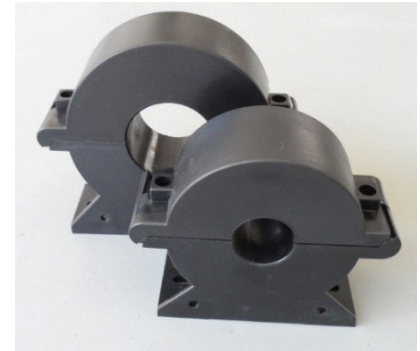
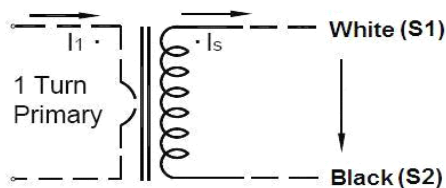

### ◆ Technique Index

Electrical Parameter		Mechanical Parameter	
Frequency	50-400Hz	Case	PC /UL94-V0
Rated Input	5A-1000A	Bobbin	PBT
Measuring range	5%In-130%In	Core	Silicon steel
Rated Output	0-10V(AC) or 0-5A	Internal structure	Epoxy
Ratio	$\leq \pm 0.2\%$	Construction	Tie
Phase angle	$\leq \pm 10\text{min}$	Operating Temp	$-25^{\circ}\text{C} \sim +75^{\circ}\text{C}$
Dielectric strength	2.5KV/1mA/1min	Operating Humidity	$\leq 85\%$
Insulation Resistance	DC500V/100MΩ min	Output Connection	UL1015 22AWG Wire(twinsted wire) 2.5m

### ◆ Type Selection (Output: mA/V)

Mfg P/N	Rated Input (A)	Output (mA/V)	Accuracy	Dimensions(mm/inch)									
				Ø	A	B	C	D	E	F	G	Ø1	Ø2
<b>SCTK673A-025</b>	5-400A (5、100、250、400A)	0-200mA 0-10V	0.2、0.5、1.0	25	100	100	42	60	87	72	22	16	5
				(1.0)	(3.9)	(3.9)	(1.7)	(2.4)	(3.4)	(2.8)	(0.9)	(0.6)	(0.2)
<b>SCTK673B-045</b>	50-1000A (50、250、400、1000A)	0-500mA 0-10V	0.2、0.5、1.0	45	123	123	42	80	109	94	23	16	5
				(1.8)	(4.8)	(4.8)	(1.7)	(3.1)	(4.3)	(3.7)	(0.9)	(0.6)	(0.2)